

cosign  
by arx

The Digital Signature Company

 **Pitney Bowes**

ARX | 855 Folsom St. Suite 939, San Francisco, CA 94107 | Tel. (415) 839-8161 | [www.arx.com](http://www.arx.com) | [sales@arx.com](mailto:sales@arx.com)

Pitney Bowes SA | Midrand, Johannesburg | Tel. (011) 516-9400 | [www.pitneybowes.co.za](http://www.pitneybowes.co.za) | [leon@pitneybowes.co.za](mailto:leon@pitneybowes.co.za)

## CoSign: The Most Widely Used Digital Signature Solution

Organizations around the world have invested in business automation solutions to streamline their workflows, improve their efficiency and cut costs. These developments have established digital business processes which try to ensure that documents, forms, and reports remain paper-free throughout their entire lifecycles.

Organizations greatly benefit from these automated processes up to the point where paper must be reintroduced just in order to collect 'wet ink' signatures. This significantly reduces the value of automation by bringing business to a halt, generating unnecessary paper-based expenditures, and limiting organizational efficiency.

### CoSign Offers a Complete Digital Signature Solution

CoSign® has helped enterprises, SMBs and government organizations around the world rapidly transform their signature-dependent processes from paper-intensive to paper-free. Our millions of users are proof of how easy it is to quickly achieve ROI by significantly reducing process times and cutting paper-related costs.

By making it simple to digitally sign documents, contracts, forms and records, CoSign eliminates the need for slow and expensive paper-based signing processes, while creating legally enforceable signatures that provide the integrity and trust required for audits, compliance with industry regulations, and good business practices.

CoSign provides a fully featured digital signature solution which can be deployed either on-premises (CoSign Central) or hosted (CoSign Cloud). Both options can help you quickly establish fully digital signature-dependent processes by:

- ▶ Providing an easy way for you to sign all major file types directly within widely-used applications, such as Microsoft Word, Excel and SharePoint.
- ▶ Integrating seamlessly with your existing DM, ECM and workflow systems, including SharePoint, K2, Nintex, OpenText, Oracle, Alfresco and more.
- ▶ Allowing users to sign anywhere from any computer, tablet or mobile device.
- ▶ Enabling anyone to easily verify the signer's identity and intent, as well as the document's integrity, using any Microsoft Office application or PDF reader.
- ▶ Ensuring that you do not have to make any changes to your existing workflows, operational processes, security procedures, and governance policies.
- ▶ Guaranteeing security so that you can be sure your sensitive data remains within your IT domain and is never saved on third party servers.
- ▶ Creating legally enforceable signatures that are compliant with even the strictest industry-specific regulations and country-specific legislation.

If you have any questions or would like further information, please visit us at [www.arx.com](http://www.arx.com) or send us an email at [sales@arx.com](mailto:sales@arx.com).





## CoSign Ensures Control and Security

- Keeps your signed documents within your enterprise IT domain, never saving them on any external third-party servers.
- Adapts to your existing processes, governance policies and SOPs, instead of forcing you to adopt rigid workflows.
- Integrates with the user directories and enrollment methods that meet your user management and authentication requirements.



## CoSign Allows Compliance

- Complies with strict industry and governmental regulations including ESIGN, UETA, EU directives and VAT law, FDA 21 CFR Part 11, USDA, SOX, and many more.
- Supplies easily verifiable proof of signer identity, signer intent and document integrity.
- Offers signatures that can be validated by anyone at any time using widely available applications such as Microsoft Office or any PDF reader.



## CoSign Delivers Low TCO & Rapid ROI

- Puts you on the path to a rapid ROI by significantly reducing paper-related costs, decreasing document turnaround times, and improving efficiency.
- Installs quickly and easily with minimal operational impact, followed up by less than 10 hours of IT maintenance work per year.
- Offers multiple options and flexible licensing based on user volume and/or access and application requirements.



## CoSign Provides Freedom of Choice

- Works with the content authoring applications and file types you are already using, including Word, Excel, Outlook, PDF, PDF/A, InfoPath, TIFF, AutoCAD and many more.
- Integrates directly into your existing document management and workflow automation systems, including SharePoint, OpenText, Oracle, Alfresco, Nintex, K2 and more.
- Allows your users to sign wherever and whenever they need, whether at the office on their PC, at home on their tablet, or in the field using a mobile device.

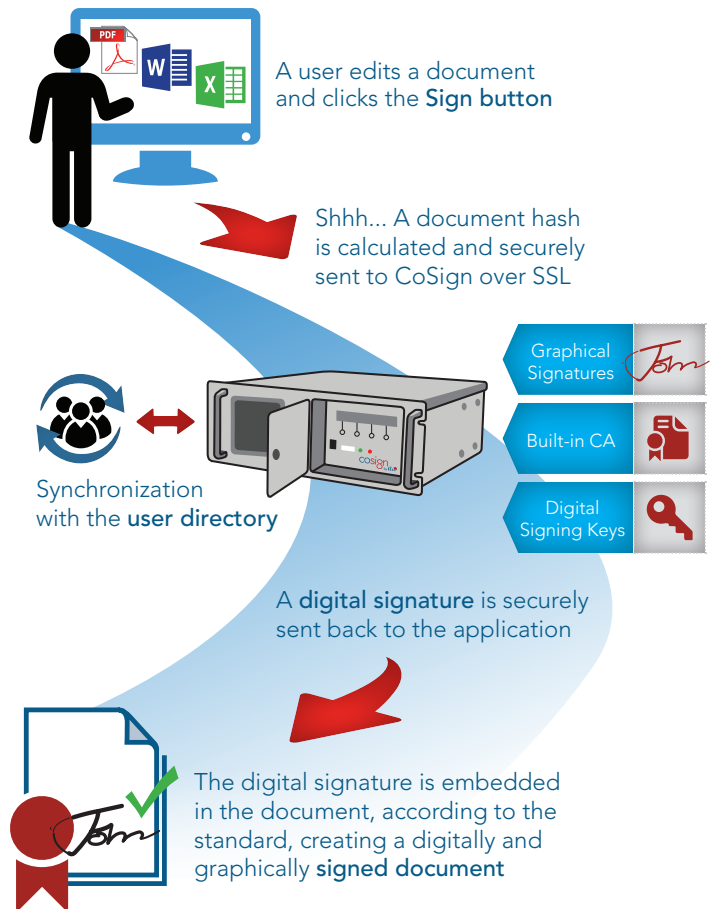

# Technical Specifications

## Applications and File Types

- Microsoft Word, Excel, PowerPoint and Outlook
- Microsoft SharePoint and InfoPath
- AutoCAD, Bentley MicroStation
- PDF, TIFF, XML, and many more

## Document/Workflow Management Systems

- Microsoft SharePoint, K2 and Nintex
- OpenText, Oracle, Alfresco and Laserfiche
- Siemens Teamcenter, SAP, Adobe LiveCycle
- Agile Frameworks, Box, Google Drive, NextDocs
- Additional ECMs and industry-specific applications

## Signature Features

- Standard digital signatures (PKI Inside)
- Easily verifiable non-proprietary signatures
- Proof of identity, intent and integrity
- Multiple signers per document
- Multiple graphical signatures per user
- Graphical signature image management
- Sectional and interdependent signatures
- Customizable signature block
- Unattended and batch signing
- Audit trail and secured time stamps
- Invisible signatures

## Certification Authority (CA)

- CoSign Internal (controlled-trust) CA
- Automatic web-trusted CA
- Subordinate CA or External CA

## Authentication Methods

- User Name/ Password
- Single Sign On
- One-Time Password (OTP)
- Tokens (Smart Cards, USB-based security tokens)
- Biometric
- RADIUS or OATH-based authentication
- LexisNexis InstantID
- SAML 2.0

## Supported APIs

- CoSign Signature API (SAPI®)
- Web Services Ready (OASIS DSS, Adobe Roaming ID ASSP, and SPML)
- Microsoft CAPI and CAPI-NG
- PKCS#11
- JCA/JCE

## User Directories

- Microsoft Active Directory
- LDAP-based Directories
- Active Directory Federation Services (ADFS)
- Directory Independent Installation

## Security Standards

- NIST FIPS 140-2 level 3 validated appliance
- FIPS 186 and ETSI TS 101 733
- CoSign Central is currently undergoing Common Criteria EAL 4 + evaluation for SSCD (Secure Signature Creation Device) certification

## Additional Features

- High availability and load balancing
- Can be powered by two power sources
- Supports unlimited number of signers
- High performance signing

## Physical Dimensions (CoSign Central)

- 1U Rack-Mountable -  
18.9" x 22.0" x 1.8" / 47.9cm x 55.9cm x 4.5cm (28 lbs / 12.7 kg)
- 4U Rack-Mountable (FIPS 140-2 level 3) -  
19.0" x 17.5" x 7.0" / 48.3cm x 44.5cm x 17.8cm  
(30 lbs / 13.6 kg)



January 2014  
 © ARX, Inc. and/or Algorithmic Research Ltd.  
 CoSign and SAPI are registered trademarks of Algorithmic Research, Ltd. All rights reserved worldwide.  
 All other brands and product names are registered trademarks or trademarks of their respective owners.